



## USER MANUAL

### 使用說明書

## 3" GRINDER (CUT-OFF)

鋰電無碳刷3"切割/砂輪機

**BEX®**  
Be Xcellent

Located on the toolhousing are the model and serial numbers of your tool, please record these.

請您紀錄位於包裝盒上的工具型號與序號。

Model Number: \_\_\_\_\_  
型號

Serial Number: \_\_\_\_\_  
序號

WWW.BEXTOOL.COM

Made in Taiwan



IMPROPER AND UNSAFE USE OF THIS TOOL WILL RESULT IN DEATH OR SERIOUS INJURY. IT IS VERY IMPORTANT THAT THE INTENDED OPERATOR OF THIS TOOL READS AND UNDERSTANDS THIS MANUAL BEFORE OPERATING THIS TOOL. KEEP THIS MANUAL AVAILABLE FOR OTHERS BEFORE THEY USE THE TOOL.



不當或不安全使用本工具可能導致死亡或嚴重傷害。  
操作本工具的使用者務必在操作前仔細閱讀並理解本手冊內容。請將本手冊保留，供其他使用者在使用工具前參閱。



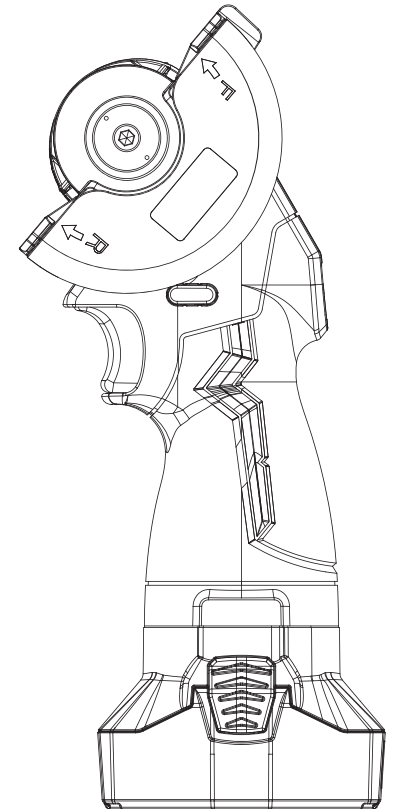

▲ **WARNING:** Please read the instructions and warnings for this tool carefully before use. Failure to do so could lead to serious injury.

▲ **重要事項:** 使用本工具前，請仔細閱讀操作說明與警告內容。  
未遵守可能導致嚴重傷害。



**GA300**

#### Explanation of symbols

Wear eye protectors	Warning	Read instruction before use	Wear hearing protectors
			
Direct current	Rated Revolutions per Minute (RPM)	Volts	
<b>D.C.</b>	n XXXX min <sup>-1</sup>	<b>V</b>	

#### Noise – GA300

The typical A-weighted noise level determined according to EN62841-2-3 :

Sound pressure level (LpA) : 86.9 dB(A)

Sound power level (LWA) : 97.9 dB(A)

Uncertainty (K) : 3 dB(A)

**NOTE** : The declared noise emission value(s) has been measured in accordance with a standard test method and may be used for comparing one tool with another.

**NOTE** : The declared noise emission value(s) may also be used in a preliminary assessment of exposure.

- ▲ **WARNING : Wear ear protection**
- ▲ **WARNING : The noise emission during actual use of the power tool can differ from the declared value(s) depending on the ways in which the tool is used especially what kind of workpiece is processed.**
- ▲ **WARNING : Be sure to identify safety measures to protect the operator that are based on an estimation of exposure in the actual conditions of use (taking account of all parts of the operating cycle such as the times when the tool is switched off and when it is running idle in addition to the trigger time).**

#### Vibration – GA300

The vibration total value determined according to EN62841-2-3:

Vibration emission (ah) : 13.69 m/S<sup>2</sup> or less

Uncertainty (K) : 1.5 m/ S<sup>2</sup>

**NOTE** : The declared vibration total value(s) has been measured in accordance with a standard test method and may be used for comparing one tool with another.

**NOTE** : The declared vibration total value(s) may also be used in a preliminary assessment of exposure.

- ▲ **WARNING : The declared vibration total value(s) has been measured in accordance with a standard test method and may be used for comparing one tool with another.**
- ▲ **WARNING : Be sure to identify safety measure to protect the operator that are based on an estimation of exposure in the actual conditions of use (taking account of all parts of the operating cycle such as the times when the tool is switched off and when it is running idle in addition to the trigger time).**

#### FCC

This device complies with part 15 of the FCC Rules. Operation is subject to the following two conditions:

- (1) This device may not cause harmful interference and
- (2) This device must accept any interference received, including interference that may cause undesired operation.

# Table of Content

General power tool safety Warning	03
Specific Safety Rules for Grinder and Cutoff	05
Specifications	06
Assembly and Instruction	06
Operation	08
Battery Specification & Safety	09
Battery Charger Safety	10
Maintenance	11
Trouble shooting	12

## General power tool safety Warning

**▲ WARNING** Read all safety warnings, instructions, illustrations and specifications. Failure to follow all instructions listed below may result in electric shock, fire and/or serious injury. **Save all warnings and instructions for future reference.**

The term "power tool" in the warnings refers to your mains-operated (corded) power tool or battery-operated (cordless) power tool.

**Hold the power tool by insulated gripping surfaces, when performing an operation where the fastener may contact hidden wiring or its own cord.** Fasteners contacting a "live" wire may make exposed metal parts of the power tool "live" and could give the operator an electric shock.

## General Power Tool Safety Warnings -Work area safety

- a) **Keep work area clean and well lit.** Cluttered or dark areas invite accidents.
- b) **Do not operate power tools in explosive atmospheres, such as in the presence of flammable liquids, gases or dust.** Power tools create sparks which may ignite the dust or fumes.
- c) **Keep children and bystanders away while operating a power tool.** Distractions can cause you to lose control.

## General Power Tool Safety Warnings

### -Electrical safety

- a) **Power tool plugs must match the outlet. Never modify the plug in any way. Do not use any adapter plugs with earthed (grounded) power tools.** Unmodified plugs and matching outlets will reduce risk of electric shock.
- b) **Avoid body contact with earthed or grounded surfaces such as pipes, radiators, ranges and refrigerators.** There is an increased risk of electric shock if your body is earthed or grounded.
- c) **Do not expose power tools to rain or wet conditions.** Water entering a power tool will increase the risk of electric shock.
- d) **Do not abuse the cord. Never use the cord for carrying, pulling or unplugging the power tool. Keep cord away from heat, oil, sharp edges or moving parts.** Damaged or entangled cords increase the risk of electric shock.
- e) **When operating a power tool outdoors, use an extension cord suitable for outdoor use.** Use of a cord suitable for outdoor use reduces the risk of electric shock.

f) **If operating a power tool in a damp location is unavoidable, use a residual current device (GFCI) protected supply.** Use of an GFCI reduces the risk of electric shock.

## General Power Tool Safety Warnings- Personal safety

- a) **Stay alert, watch what you are doing and use common sense when operating a power tool. Do not use a power tool while you are tired or under the influence of drugs, alcohol or medication.** A moment of inattention while operating power tools may result in serious personal injury.
- b) **Use personal protective equipment. Always wear eye protection.** Protective equipment such as dust mask, non-skid safety shoes, hard hat, or hearing protection used for appropriate conditions will reduce personal injuries.
- c) **Prevent unintentional starting. Ensure the switch is in the off-position before connecting to battery, picking up or carrying the tool.** Carrying power tools with your finger on the switch or energizing power tools that have the switch on invites accidents.
- d) **Remove any adjusting key or wrench before turning the power tool on.** A wrench or a key left attached to a rotating part of the power tool may result in personal injury.
- e) **Do not overreach. Keep proper footing and balance at all times.** This enables better control of the power tool in unexpected situations.
- f) **Dress properly. Do not wear loose clothing or jewellery. Keep your hair, clothing and gloves away from moving parts.** Loose clothes, jewellery or long hair can be caught in moving parts.
- g) **If devices are provided for the connection of dust extraction and collection facilities, ensure these are connected and properly used.** Use of dust collection can reduce dust-related hazards.
- h) **Do not let familiarity gained from frequent use of tools allow you to become complacent and ignore tool safety principles.** A careless action can cause severe injury within a fraction of a second.
- i) **Always wear protective goggles to protect your eyes from injury when using power tools. The goggles must comply with ANSI Z87.1 in the USA, EN 166 in Europe, or AS/NZS 1336 in Australia/New Zealand. In Australia/New Zealand, it is legally required to wear a face shield to protect your face, too.**



#### General Power Tool Safety Warnings- Power tool use and care

- a) **Do not force the power tool. Use the correct power tool for your application.** The correct power tool will do the job better and safer at the rate for which it was designed.
- b) **Do not use the power tool if the switch does not turn it on and off.** Any power tool that cannot be controlled with the switch is dangerous and must be repaired.
- c) **Disconnect plug from the power source and/or the battery pack from the power tool before making any adjustments, changing accessories, or storing power tools.** Such preventive safety measures reduce the risk of starting the power tool accidentally.
- d) **Store idle power tools out of the reach of children and do not allow persons unfamiliar with the power tool or these instructions to operate the power tool.** Power tools are dangerous in the hands of untrained users.
- e) **Maintain power tools. Check for misalignment or binding of moving parts, breakage of parts and any other condition that may affect the power tool's operation. If damaged, have the power tool repaired before use.** Many accidents are caused by poorly maintained power tools.
- f) **Keep cutting tools sharp and clean.** Properly maintained cutting tools with sharp cutting edges are less likely to bind and are easier to control.
- g) **Use the power tool, accessories and tool bits etc. in accordance with these instructions, taking into account the working conditions and the work to be performed.** Use of the power tool for operations different from those intended could result in a hazardous situation.
- h) **Keep handles and grasping surfaces dry, clean and free from oil and grease.** Slippery handles and grasping surfaces do not allow for safe handling and control of the tool in unexpected situations.

#### General Power Tool Safety Warnings-Battery tool use and care

- a) **Recharge only with the charger specified by the manufacturer.** A charger that is suitable for one type of battery pack may create a risk of fire when used with another battery pack.
- b) **Use power tools only with specifically designated battery packs.** Use of any other battery packs may create a risk of injury and fire.
- c) **When battery pack is not in use, keep it away from other metal objects, like paper clips, coins, keys, nails, screws or other small metal objects, that can make a connection from one terminal to another.** Shorting the battery terminals together may cause burns or a fire.
- d) **Under abusive conditions, liquid may be ejected from the battery; avoid contact. If contact accidentally occurs, flush with water. If liquid contacts eyes, additionally seek medical help.** Liquid ejected from the battery may cause irritation or burns.
- e) **Do not use a battery pack or tool that is damaged or modified.** Damaged or modified batteries may exhibit unpredictable behavior resulting in fire, explosion or risk of injury.
- f) **Do not expose a battery pack or tool to fire or excessive temperature.** Exposure to fire or temperature above 130 °C may cause explosion.
- g) **Follow all charging instructions and do not charge the battery pack or tool outside the temperature range specified in the instructions.** Charging improperly or at temperatures outside the specified range may damage the battery and increase the risk of fire.

#### General Power Tool Safety Warnings-Service

- a) **Have your power tool serviced by a qualified repair person using only identical replacement parts.** This will ensure that the safety of the power tool is maintained.
- b) **Never service damaged battery packs.** Service of battery packs should only be performed by the manufacturer or authorized service providers.

#### Specific safety rules for Grinder and CUT OFF

- **Hold power tool by insulated gripping surfaces, when performing an operation where the cutting accessory may contact hidden wiring.** Cutting accessory contacting a "live" wire may make exposed metal parts of the power tool "live" and could give the operator an electric shock.
- **Know your power tool. Read operator's manual carefully. Learn its applications and limitations, as well as the specific potential hazards related to this power tool.** Following this rule will reduce the risk of electric shock, fire, or serious injury.
- **Protect your lungs. Wear a face or dust mask if the operation is dusty.** Following this rule will reduce the risk of serious personal injury.
- **Protect your hearing. Wear hearing protection during extended periods of operation.** Following this rule will reduce the risk of serious personal injury.
- Guards must be provided and adjusted properly as per the manufacturer's manual to protect you. Replace damaged guards because if an abrasive wheel breaks while rotating, it can cause a serious injury.
- Follow User's Manual for the safe use of grinder wheel guards.
- Do not use wheels that are cracked or those that excessively vibrate.
- Keep the power cord away from the grinding wheel and the material being ground.
- Make sure the work area is clear of flammable materials and that combustible dust is not allowed to accumulate.
- Do not "jam" the cut-off wheel or apply excessive pressure. Do not attempt to make an excessive depth of cut. Overstressing the wheel increases the loading and susceptibility to twisting or binding of the wheel in the cut and the possibility of kickback or wheel breakage
- Do not restart the cutting operation in the workpiece. Let the wheel reach full speed and carefully re-enter the cut. The wheel may bind, walk up or kickback if the power tool is restarted in the workpiece

#### Kickback and Related Warnings

- Kickback is a sudden reaction to a pinched or snagged rotating wheel, backing pad, brush or any other accessory. Pinching or snagging causes rapid stalling of the rotating accessory which in turn causes the uncontrolled power tool to be forced in the direction opposite of the accessory's rotation at the point of the binding.
- For example, if an abrasive wheel is snagged or pinched by the workpiece, the edge of the wheel that is entering into the pinch point can dig into the surface of the material causing the wheel to climb out or kick out. The wheel may either jump toward or away from the operator, depending on direction of the wheel's movement at the point of pinching. Abrasive wheels may also break under these conditions.
- Kickback is the result of power tool misuse and/or incorrect operating procedures or conditions and can be avoided by taking proper precautions as given below.
- **Maintain a firm grip with both hands on the power tool and position your body and arms to allow you to resist kickback forces. Always use auxiliary handle, if provided, for maximum control over kickback or torque reaction during start-up.** The operator can control torque reactions or kickback forces, if proper precautions are taken.
  - **Never place your hand near the rotating accessory.** Accessory may kickback over your hand.
  - **Do not position your body in the area where power tool will move if kickback occurs.** Kickback will propel the tool in direction opposite to the wheel's movement at the point of snagging.
  - **Use special care when working corners, sharp edges, etc. Avoid bouncing and snagging the accessory.** Corners, sharp edges or bouncing have a tendency to snag the rotating accessory and cause loss of control or kickback
  - **Do not attach a saw chain woodcarving blade, segmented diamond wheel with a peripheral gap greater than 10 mm or toothed saw blade.** Such blades create frequent kickback and loss of control.



### Specification

Model No	GA300
No load speed	0 – 2,0000rpm
Wheel Size	3"(76mm)
Volts	18 V D.C.
Length	125mm
Tool Weight	0.73kg
Battery Type	EB14020-A1
Charger Type	EC1412-A1

### Function Description

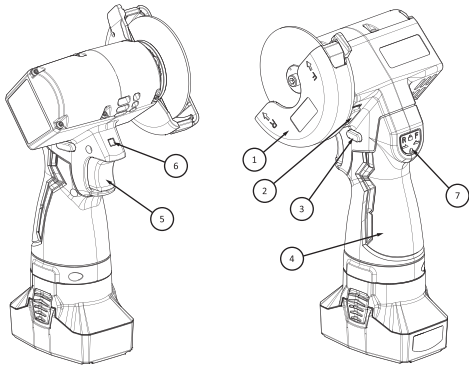

1	Guard
2	Spindle lock button
3	Control Switch
4	Handle
5	Trigger
6	LED
7	Indicator Light

### Assembly and Instruction

▲ To reduce the risk of serious personal injury, turn unit off and remove the battery pack before making any adjustments or removing / installing attachments or accessories. An accidental start-up can cause injury

■ ▲ Recharge only with the charger specified for the battery. For specific charging instructions, read the operator's manual supplied with your charger and battery.

#### ■ Removing/Inserting the Battery

To remove the battery, push in the release buttons and pull the battery pack away from the tool.

To insert the battery, slide the pack into the body of the tool. Make sure it latches securely into place.

■ ▲ Always remove battery pack before changing or removing accessories.

■ Only use accessories specifically recommended for this tool. Others may be hazardous.

■ ▲ When the grinding wheel is installed not for cut-off operations.

### Replacing the Grinding Wheels / Cutting Wheels

■ To install wheels, remove the battery pack

■ Place tool on a firm surface with the guard surface facing up.

■ Press and hold the spindle lock button to lock the spindle. You need to rotate the spindle using the provided hex key if the spindle lock button cannot be pressed down to the end

■ Loosen the clamping bolt with outer flange by turning it anti-clockwise using the provided hex key.

■ Remove the clamping bolt with outer flange and the wheel.

■ Place the wheel on the tool spindle. Ensure it is correctly located.

■ Insert the clamping bolt with outer flange through the centre of the wheel and onto the spindle.

■ Press and hold the spindle lock button to lock the spindle. You need to rotate the spindle using the provided hex key if the spindle lock button cannot be pressed down to the end.

■ Tighten the clamping bolt with washer by turning it clockwise using the provided hex key. Make sure that the grinding wheel / cutting wheel is assembled firmly.

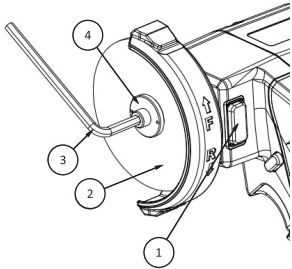

1	Spindle lock button
2	grinding wheel
3	hex key
4	Outer flange

### Adjusting the Guard

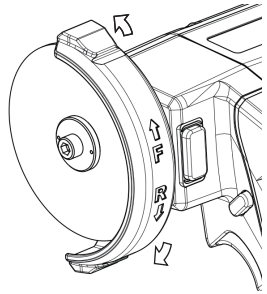

■ Remove the battery pack.

■ Grasp the guard and rotate forward or backward (60° range). Always position the guard in the location which offers best control and protection

### The protection guard for cutting installation

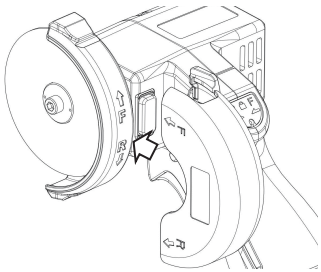

■ When using cutting wheel, The protection guard for cutting is mounted onto the protection guard for grinding until it engages

Operation

**▲ WARNING :** To reduce the risk of serious personal injury, turn unit off and remove the battery pack before making any adjustments or removing / installing attachments or accessories. An accidental start-up can cause injury.

**WARNING! DO NOT** switch the grinder on whilst the wheel is in contact with the workpiece. Allow the disc to reach full speed before starting to grind.

- Always position the guard so that as much of the exposed wheel as possible is pointing away from you
- Be prepared for a stream of sparks when the wheel touches the metal
- Use caution when working into corners as contact with the intersecting surface may cause the grinder to jump or twist.
- When grinding is complete allow the workpiece to cool
- **▲WARNING!** For cutting metal, always work with the wheel guard for cutting. When cutting, work with moderate feed, adapted to the material being cut. DO NOT exert pressure onto the cutting disc, tilt or oscillate the machine.
- **DO NOT** reduce the speed of running down cutting discs by applying sideward pressure.
- Only use grinding wheel where the printed rotational speed is at least as high as what has been specified on the label of the device.
- **DO NOT** use any broken, cracked, or otherwise damaged grinding wheel.
- Never operate the device without protective equipment.
- **Keep your hands away from the disc when the device is in operation. Risk of injury.**
- Support the plates or workpieces in order to reduce the risk of kickback from a jammed cutting disc. Large workpieces may bend under their own weight. The workpiece must be supported on both sides of the disc, not only near the cutting disc, but also at the edge.

Control Switch

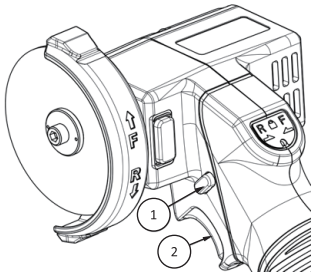

1.Control Switch 2.Trigger Switch

The control switch may be set to three positions: forward, reverse and lock. Due to a lockout mechanism, the control switch can only be adjusted when the Trigger switch is not pressed. Always allow the motor to come to a complete stop before using the control switch.

- To start the tool, Press the trigger switch. Release the trigger switch to stop.
- For **forward** (counterclockwise) rotation, push the control switch in the direction shown. **Check the direction of rotation before use.**
- For **reverse** (clockwise) rotation, push the control switch in the direction shown. **Check the direction of rotation before use.**

BATTERY SPECIFICATION & SAFETY

EB14020-A1	
Rated Voltage	14.4V
Rated Capacity	2Ah
Cell type	Li-ion
Dimension	L x W x H 89x59.1x105.2 (mm)

- Do not throw the battery into fire, nor heat the battery.
  - Do not disassemble nor modify the battery Pack.
  - Do not leave the battery in a place of high temperature.( 60°C or more)
  - To prevent the battery from water or moisture.
  - Do not add strong shock, nor drop the battery.
  - Do not solder lead directly to the battery body.
  - Do not heat nor solder the terminals of the battery.
  - Do not short “+”and “-”terminal of the battery with a kind of metal.
  - Do not charge beyond the condition which described on the delivery specification.
  - Do not reverse-charge or reverse-connect the battery.
  - When recharging, please use a special charger (EC1412-A1).
  - Please regularly check the battery capacity. When the voltage of the battery is lower than the terminal voltage, its capacity may drop and cannot be recovered.
  - If the battery is stored over 3 months, it should be checked again about the remaining capacity and charge the battery.
- Remarks: Please refer to the technical data sheet for the battery specifications.**

BATTERY SPECIFICATION & SAFETY

Battery Charger Specification	
Charger	EC1412-A1
Battery mode	EB14020-A1
Output voltage	16.6V for EB14020-A1
Protection class	Electrical protection class II
AC supply voltage	100VAC~240VAC
Mains frequency	50Hz~60Hz
Operating Temperature	0°C to 45°C
Storage Temperature	-20°C to 70°C

State of Charge indicator			
	State	Red LED	Green LED
1	Stand-by Mode	OFF	flashes (0.5sec ON, 0.5sec OFF)
2	Battery Pack Install And Charging	ON	OFF
3	CV Constant voltage charging mode	OFF	flashes (0.1sec ON, 0.1sec OFF)
4	CC Constant current charging mode	ON	OFF
5	Charging complete	OFF	ON
6	Temperature protection	Red LED flashes	
7	Abnormal Protection	Red & Green LED all on	

## Battery Charger Safety

- **Keep work area clean and well lit.** Cluttered and dark areas invite accidents.
- **Do not operate the appliance in explosive atmospheres, such as in the presence of flammable liquids, gases or dust.** Chargers can cause sparks which may ignite dust or fumes.
- **Keep children and other persons away from the area while the charger is in use.**
- **The supply cord plug must match the outlet. Modification of the plug in any way is not permissible.** Unmodified plugs and corresponding power outlets reduce the risk of electric shock.
- **Avoid body contact with earthed or grounded surfaces such as pipes, radiators, ranges and refrigerators.** There is an increased risk of electric shock if your body is earthed or grounded.
- **Do not abuse the supply cord. Never use the supply cord to carry, pull or unplug the appliance. Keep the cord away from heat, oil, sharp edges or moving parts.** Damaged or entangled cords increase the risk of electric shock.
- **Only use the battery charger in areas which are dry.** Water entering an electric appliance increases the risk of electric shock.
- **Use the charger only to charge the batteries approved for use with this charger.**
- **Do not use a charger if its casing or electric supply cord is defective.**
- **Store chargers out of reach of children when not in use. Do not allow persons unfamiliar with the appliance or these instructions to operate it.** Chargers are dangerous in the hands of untrained users.
- **Maintain the appliance carefully. Check to ensure that no parts are broken or damaged in such a way that the appliance can no longer function correctly. If damaged, have the appliance repaired before use.**

- **Use chargers and the corresponding batteries in accordance with these instructions and as is specified for this particular model.** Use of chargers for applications different from those intended could result in hazardous situations.
- **Recharge only with the charger specified by the manufacturer.** A charger that is suitable for one type of battery pack may create a risk of fire when used with another battery pack.
- **When not in use, keep the battery and the charger away from paper clips, coins, keys, nails, screws or other small metal objects that could cause a short circuit at the battery terminals or the charging contacts.** A short circuit at the battery terminals or charging contacts could result in personal injury (burns) or fire.
- **Under abusive conditions, liquid may be ejected from the battery. Avoid contact with the liquid. If contact accidentally occurs, flush with water. If the liquid comes into contact with the eyes also consult a doctor.** Liquids ejected from the battery may cause irritation or burns.
- **Take care to ensure that the charger is standing in a steady, secure position.** A falling battery or charger may present a risk of injury to yourself or others.
- **Avoid touching the contacts.**
- **Batteries that have reached the end of their life must be disposed of safely and correctly to avoid environmental pollution.**
- **This appliance is not intended for use by persons (including children) with reduced physical, sensory or mental capabilities, or lack of experience and knowledge, unless they have been given super-vision or instruction concerning use of the appliance by a person responsible for their safety.**
- **Children must be instructed not to play with the appliance.**
- **Take care to ensure that the batteries suffer no mechanical damage**
- **Do not charge or continue to use damaged batteries (e.g. batteries with cracks, broken parts, bent or pushed-in and/or pulled-out contacts).**

-  **Do not touch the supply cord or extension cord if they are damaged while working. Disconnect the supply cord plug from the power outlet.** Damaged supply cords or extension cords present a risk of electric shock.
- **Never operate the appliance when it is dirty or wet. Under unfavorable conditions, dampness or dust adhering to the surface of the appliance, especially dust from conductive materials, may present a risk of electric shock. Dirty or dusty appliances should thus be checked at a service center at regular intervals, especially if used frequently for working on conductive materials.**

## Maintenance

**▲ WARNING: To reduce the risk of injury, always unplug the charger and remove the battery pack from the charger or tool before performing any maintenance. Never disassemble the tool, battery pack or charger. Contact a Service facility for ALL repairs.**

### Maintaining Tool

- **Keep your tool, battery pack and charger in good repair by adopting a regular maintenance program.** Inspect your tool for issues such as undue noise, misalignment or binding of moving parts, breakage of parts, or any other condition that may affect the tool operation. Return the tool, battery pack, and charger to a Service for dealers.
- **If the tool does not start or operate at full power with a fully charged battery pack, clean the contacts on the battery pack. If the tool still does not work properly return the tool, charger and battery pack, to a Service for dealers.**

**▲ WARNING: To reduce the risk of personal injury and damage, never immerse your tool, battery pack or charger in liquid or allow a liquid to flow inside them.**

### Cleaning

- **Clean dust and debris from vents. Keep handles clean, dry and free of oil or grease.**
- **Use only mild soap and a damp cloth to clean, since certain cleaning agents and solvents are harmful to plastics and other insulated parts. Some of these include gasoline, turpentine, lacquer thinner, paint thinner, chlorinated cleaning solvents, ammonia and household detergents containing ammonia.**
- **Never use flammable or combustible solvents around tools.**

### Repairs

For repairs, return the tool, battery pack and charger to the nearest service center.

### Troubleshooting

When protection occurs, Indicator Light of the tool will flash to prompt, and the details are shown in the table below

【Note】Flashing at intervals of 1.5 seconds and at a flashing frequency of 0.25 seconds

Symptom	Occurred abnormal	Troubleshooting
Continuously blinks once.	■ Battery voltage protection.	■ Leave Tool, reinsert the battery, and press the trigger. ■ Replace a fully charged battery, and press the trigger. ■ Contact Service if the problem persists.
Continuously blinks 2 times.	■ Tool motor temperature protection. ■ Tool battery temperature protection. ■ Tool Control board temperature protection.	■ Leave Tool reinsert the battery, and press the trigger. ■ Remove battery, wait temperature recover and reinsert battery. ■ Contact Service if the problem persists.
Continuously blinks 3 times.	■ Tool over current.	■ Leave Tool, reinsert the battery, and press the trigger. ■ Contact Service if the problem persists.
The tool doesn't work and the battery status not displayed blinks.	■ Tool motor abnormal.	■ Leave Tool, reinsert the battery, and press the trigger. ■ Contact Service if the problem persists.
For failure other than above situation, please stop using the tool and contact your local dealer for service.		

Tel:+886-4-2359-8877

Address:No. 24, 36th Road, Taichung Industrial Park Taichung, Taiwan

符號說明

佩戴護目鏡	警告	使用前請先詳讀說明書	佩戴聽力保護裝置
			
直流電	每分鐘轉速	伏特	
<b>D.C.</b>	n XXXX min <sup>-1</sup>	<b>V</b>	

噪聲 – GA300

根據 EN62841-2-3 標準測定的典型 A 加權噪音級：  
聲壓級(LpA)：86.9 分貝(A)  
聲功率等級(LWA)：97.9 分貝(A)  
不確定性的測量 (K)：3 分貝 (A)

注意：所聲明的噪音排放值是依據標準測試方法測得的，可用於比較不同工具之間的噪音等級。

注意：所聲明的噪音排放值亦可用於初步評估暴露情況。

- ▲ 警告：請佩戴聽力保護裝置
- ▲ 警告：實際使用電動工具時的噪音排放可能會因工具的使用方式，尤其是加工的工件類型而與聲明值有所不同。
- ▲ 警告：確保根據實際使用條件 (包括工具關閉時、空轉時以及觸發時的所有操作循環部分) 估算暴露情況，制定保護操作員的安全措施。

振動 – GA300

根據 EN62841-2-3 標準測定的總振動值：  
振動產生值 (ah)：13.69 m/S<sup>2</sup>，或更低  
不確定性的測量 (K)：1.5 m/S<sup>2</sup>

注意：所聲明的總振動值是依據標準測試方法測得的，可用於比較不同工具之間的振動程度。

注意：所聲明的總振動值亦可用於初步評估暴露情況。

- ▲ 警告：所聲明的總振動值是依據標準測試方法測得的，可用於比較不同工具之間的振動程度。
- ▲ 警告：確保根據實際使用條件 (包括工具關閉時、空轉時以及觸發時的所有操作循環部分) 估算暴露情況，制定保護操作員的安全措施。

聯邦通訊委員會 (FCC)

本設備符合聯邦通信委員會 (FCC) 規則第 15 部分。操作必須符合以下兩個條件：

- (1) 本設備不會造成有害干擾訊號，並且
- (2) 本設備必須接受任何接收到的干擾，包括可能導致操作不正常的干擾訊號。



## 目錄

一般電動工具安全警告	17
切割/砂輪機使用安全規則	19
規格	20
組裝與說明	20
操作	22
電池規格與安全使用事項	23
電池充電器安全使用事項	24
維護保養	25
故障排除	26

### 一般電動工具安全警告

▲警告：請閱讀所有的安全警告、使用說明、圖片和規格。未遵守以下所有的使用說明可能導致觸電、引發火災或造成嚴重受傷。請保留所有的警告和使用說明以供日後參考。

在警告中，「電動工具」指的是您的插電式電動工具或電池式電動工具。

在進行緊固件可能使接觸到隱藏電線或工具自身電線的操作時，請握住電動工具的絕緣握持表面。緊固件接觸到「帶電」的電線可能會導致電動工具的金屬外露部分「通電」，從而使操作人員遭受電擊。

### 一般電動工具安全警告-工作場地安全

- a) 請保持工作場地乾淨且明亮。雜亂或昏暗的環境容易引發事故。
- b) 請勿在易爆環境中操作電動工具，例如在有易燃液體、氣體或粉塵的環境中。電動工具會產生火花，可能引燃粉塵或氣體。
- c) 操作電動工具時，請讓兒童和旁觀者遠離。分心可能讓您無法安全操作工具。

### 一般電動工具安全警告-用電安全

- a) 電動工具的插頭必須與插座相匹配。請勿以任何方式改裝插頭。需接地的電動工具不能使用任何轉接插頭。未經改裝的插頭和匹配的插座能降低電擊危險。
- b) 避免身體與接地的表面(如管道、散熱器、爐具和冰箱)接觸。如果身體接觸接地的表面，會增加電擊危險。
- c) 不要將電動工具暴露於雨水或潮濕環境中。若有水進入電動工具會增加電擊危險。
- d) 請勿以錯誤方式使用電源線。請勿用電線來進行搬運、拉動或拔掉電動工具。避免電線接觸高溫、油污、尖銳邊緣或活動零件。受損或纏繞的電線會增加觸電風險。
- e) 在戶外操作電動工具時，請使用適合戶外使用的延長線。使用戶外專用的電線可以降低電擊危險。
- f) 若無法避免在潮濕的地方操作電動工具，請使用漏電保護裝置(GFCI)。使用GFCI可降低觸電的風險。

### 一般電動工具安全警告-人身安全

- a) 在操作電動工具時，請保持警覺，依據常識判斷當下作業需求和環境。不要在疲倦或受藥物、酒精或藥品影響時使用電動工具。在操作電動工具時，瞬間的疏忽可能導致嚴重人身傷害。
- b) 用個人防護裝備始終佩戴護目鏡。在適當條件下佩戴防塵口罩、穿上防滑安全鞋、戴安全帽或聽力保護裝備等防護設備，可以有效減少人員受傷。
- c) 防止工具意外啟動。在連接電池、提起或搬運工具前，確保開關處於關閉位置。搬運電動工具時手指放在開關上，或啟動開關處於開啟狀態的工具，容易導致事故發生。
- d) 在電動工具接通之前，取下所有定位鍵或扳手。遺留在電動工具旋轉零件上的扳手或定位鍵有可能會導致人身傷害。
- e) 請避免伸手去拿取工具。時刻注意立足點和身體平衡。這有助於在突發情況下更好地控制電動工具。
- f) 穿著適當。避免穿寬鬆的衣物或佩戴首飾。將頭髮、衣物和手套遠離活動零件。寬鬆的衣服、首飾或長髮可能會被活動零件捲入，導致危險。
- g) 如果提供了與排屑、集塵設備連接用的裝置，要確保他們連接完好且使用得當。使用集塵設備可減少因塵屑引起的危險。
- h) 請勿因頻繁使用本工具而自認熟練導致您大意輕忽工具的安全原則。一時的疏忽隨即會造成人身重傷。
- i) 使用電動工具時，請務必佩戴護目鏡，以防眼睛受到傷害。護目鏡需符合美國 ANSI Z87.1 標準、歐洲 EN 166 標準或澳洲／紐西蘭 AS/NZS 1336 標準。若於澳洲／紐西蘭地區，法定需佩戴面罩以保護臉部。



## 一般電動工具安全警告

### -電動工具使用和注意事項

- 使用適當的電動工具。根據您的需求選擇正確的電動工具。正確的電動工具能以其設計的速度更高效、更安全地完成工作。
- 如果電動工具的開關無法接通或關閉，請勿使用該工具。任何無法透過開關控制的電動工具都是危險的，且必須進行修理。
- 在進行任何調整、更換配件或貯存電動工具之前，請先將插頭從電源上拔掉，或將電池從電動工具上取下。這些預防性安全措施能降低意外啟動電動工具的危險。
- 閒置的電動工具貯存在兒童無法拿到的地方，並且不要讓不熟悉該電動工具或對這些說明不了解的人操作它。讓未經訓練的使用者操作電動工具是相當危險的。
- 請定期維護電動工具。檢查工具是否存在異常噪音、活動零件對不准或卡住、零件破損或任何其他可能影響工具操作的情況。如果有損壞，請在使用前送修完畢。不良維護的電動工具是造成事故的主要原因之一。
- 保持切削刀具鋒利和清潔。保養良好的有鋒利切削刀的刀具不易被卡住而且容易控制。
- 按照使用說明書，考慮作業條件和進行的作業來使用電動工具、配件和工具的鑽頭等。將電動工具用於那些與其用途不符的操作可能會導致危險。
- 把手及握持區應保持乾燥、潔淨，且不得沾染任何油液或油脂。易滑脫的把手及握持區將無法讓您在發生意外狀況時安全地抓緊並控制工具。

## 一般電動工具安全警告

### -電池式工具使用和注意事項

- 僅使用原廠指定的充電器進行充電。適用於一種電池組的充電器，若用於其他電池組，可能會引發火災風險。
- 只有在配有專用電池組的情況下才使用電動工具。使用其他電池組可能會發生損壞和著火危險。
- 當電池組未使用時，請將其遠離其他金屬物品，如迴紋針、硬幣、鑰匙、釘子、螺絲或其他小型金屬物品，以防一端與另一端連接。電池端部短路會引起燃燒或火災。
- 在不當的使用情況下，電池可能會釋放液體；請避免接觸。如不慎接觸，請用水沖洗。如液體接觸眼睛，請立即尋求醫療協助。電池釋放的液體可能會引起刺激或灼傷。
- 請勿使用損壞或改裝過的電池組或工具。損壞或改裝過的電池可能會出現無法預期的反應，導致火災、爆炸或人身受傷風險。
- 請勿將電池組或工具暴露於火源或高溫環境中。暴露於火源或高於130°C的溫度可能會導致爆炸。
- 遵循所有充電指示，並請勿在說明書規定的溫度範圍外為電池組或工具充電。不正確的充電方式或在規定溫度範圍外充電可能會損壞電池，並增加火災風險。

### 一般電動工具安全警告-維修

- 請由合格的維修人員使用相同的替換零件來維修您的電動工具。這將確保所維修的電動工具的安全性。
- 請勿自行維修已損壞的電池組。電池組的維修應僅由原廠或授權服務商來進行維修。

## 切割/砂輪機使用安全規則

- 在執行可能使切割配件接觸到隱藏電線的操作時，請握住電動工具的絕緣握持表面。切割配件接觸到「帶電」電線可能會導致電動工具的金屬外露部分「通電」，從而使操作人員觸電。
- 熟悉您的電動工具。請仔細閱讀操作手冊。了解其應用範圍與限制，以及與該電動工具相關的特定潛在危害。遵守此規則可降低觸電、火災或嚴重受傷。
- 保護您的肺部。若操作過程中產生粉塵，請佩戴面罩或防塵口罩。遵守此規則可降低嚴重人員受傷的風險。
- 保護您的聽力。在長時間操作期間，請佩戴聽力防護裝置。遵守此規則可降低嚴重人員受傷的風險。
- 防護裝置必須正確安裝與調整，按照原廠手冊進行調整以保護自身安全。如防護裝置損壞，請立即更換，因為砂輪在旋轉時若發生破裂，可能導致嚴重傷害。
- 按照使用手冊中的指示安全使用磨輪防護擋板。
- 請勿使用有裂痕或振動過大的砂輪。
- 將電源線遠離砂輪和正在磨削的材料。
- 確保工作區域沒有易燃材料，且沒有粉塵堆積。
- 請勿使切割片「卡死」或施以太大的壓力。請勿嘗試進行過深的切割。過度施壓會增加砂輪負荷，並使輪片更容易在切割過程中扭曲或卡住，從而增加反彈或輪片破裂的風險。
- 請勿在工件中重新啟動切割操作。讓砂輪達到全速後，再小心地重新進入切割。若在工件中重新啟動電動工具，砂輪可能會卡住、滑動或產生回彈。

## 回彈與相關安全說明

回彈是正在旋轉的砂輪、襯墊、鋼絲刷或其它配件夾住或卡住時突然產生的反作用力。夾住或卡住會導致旋轉配件的迅速停滯，從而導致無法控制的電動工具被強行推向與配件旋轉方向相反的方向。

例如，如果砂輪被工件夾住或卡住，進入夾緊點的砂輪邊緣將進入工件材料的表面，導致砂輪脫離或彈出。根據砂輪在夾緊點的運動方向，砂輪可能會跳向或遠離操作者。

在這種情況下，砂輪也可能會破裂。

回彈是由於電動工具使用不當和/或操作程序或條件不正確所造成的，可以通過採取以下適當的預防措施來避免。

- 請將雙手請緊握住電動工具，並穩住您的雙臂和身體，以便能控制住回彈衝擊力。在啟動過程中，如果有輔助握把，請一定要配合使用，來最大程度地控制回彈或轉矩反作用力。如果遵守正確的注意事項，操作者可控制轉矩反作用力或回彈力。
- 無論任何時候都請勿將手靠近旋轉中的配件。回彈可能會使配件彈回到您的手上。
- 請勿站立在發生回彈發生時電動工具運轉的範圍中。回彈發生時，會將工具推向與砂輪在卡住點處運動方向相反的方向。
- 在處理邊角、銳利邊緣等時要特別小心。避免配件反彈或被卡住的現象。邊角、銳利的邊緣或配件發生彈跳可能會使旋轉的配件被卡住並導致工具失控或回彈。
- 請勿使用縫寬超過10 mm的鏈條鋸片、齒狀鋸片或節段型鑽石切割轉輪。此類配件工具常造成回彈，使得機具失去控制。

### 規格

型號	GA300
空載轉速	0 - 2,0000 rpm
轉輪尺寸	3"(76mm)
伏特	18V 直流電
長度	125mm
工具重量	0.73 kg
電池類型	EB14020-A1
充電器類型	EC1412-A1

### 功能描述

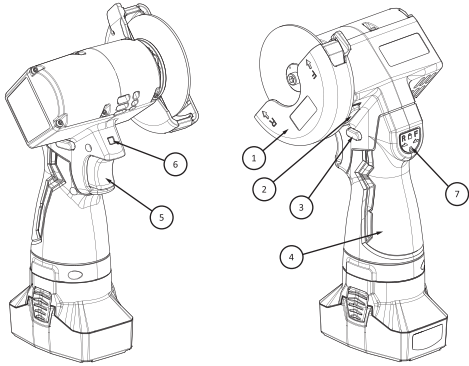

1	防護罩
2	主軸固定鈕
3	正反轉切換鈕
4	握把
5	扳機
6	LED 燈
7	指示燈

### 組裝與說明

▲ 警告：為減少嚴重人員受傷的風險，請在進行任何調整或拆卸/安裝附件或配件之前，關閉設備並移除電池組。意外啟動可能會造成傷害。

- 僅使用指定的充電器為電池充電。具體充電指示，請閱讀充電器和電池的使用手冊。
- 移除/安裝電池  
如要移除電池，請按下釋放鈕，再將電池組移除。  
如要安裝電池，將電池組插入工具。請確保電池已安裝完畢。
- ▲ 如要更換或移除配件，請先移除電池組。
- 請僅使用適用此工具的配件。使用其他不相容之配件有危險之虞。
- ▲ 砂輪安裝後，請勿進行切割動作。

### 更換砂輪/切割輪

- 安裝砂輪時，請先移除電池組。
- 將工具放在堅硬表面上，防護罩表面朝上。
- 按住主軸固定鈕以鎖定主軸。如主軸固定鈕無法按到底，請用六角扳手旋轉主軸。
- 用六角扳手逆時針轉動外緣法蘭盤的固定螺絲，將其鬆開。
- 拆下帶有外緣法蘭盤和轉輪的固定螺絲。
- 將砂輪安裝在工具主軸上。確保其正確定位並牢固安裝。
- 將帶有外緣法蘭盤的固定螺絲插入轉輪中心同時也穿過主軸。
- 按住主軸固定鈕以鎖定主軸。如主軸固定鈕無法按到底，請用六角扳手旋轉主軸。
- 以六角扳手順時針轉動，將帶有墊圈的固定螺絲鎖緊。確保砂輪/切割輪已安裝牢固。

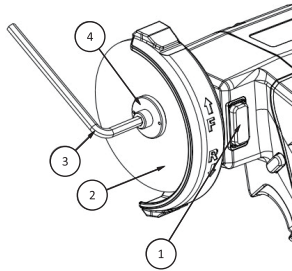

1	主軸固定鈕	3	六角扳手
2	砂輪	4	外緣法蘭盤

### 調整防護罩

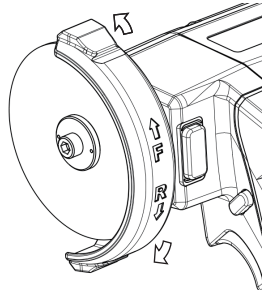

- 移除電池組
- 抓住防護罩，向前或向後旋轉 (60°)。使防護罩一直處於最好控制且保護力最佳的位置。

### 安裝切割防護砂輪罩

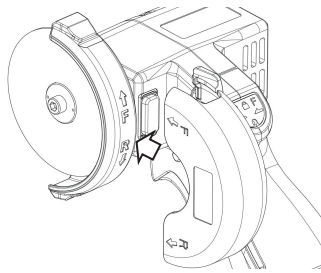

- 使用切割輪時，將切割防護罩安裝在砂輪防護罩上，直到其啟動。

## 操作

▲ **警告：**為減少嚴重人員受傷的風險，請在進行任何調整或拆卸/安裝附件或配件之前，關閉設備並移除電池組。意外啟動可能會造成傷害。

**警告！**請勿在砂輪接觸工件時啟動砂輪機。請確保砂輪達到全速後再開始研磨作業。

- 盡可能地將防護罩放在合適位置，並使暴露在外的轉輪遠離自身。
- 當轉輪接觸到金屬時，小心火花四濺。
- 在處理邊角處時請特別小心，因為兩者之交會面可能會使砂輪機彈出去或扭曲。
- 磨削完成後，請等待工件冷卻。
- 警告！**切割金屬時，務必與砂輪防護罩一起使用。在切割時，應根據材料特性以適當的進給速度操作。請勿對切割片施加過大壓力，也不要傾斜或擺動機器。
- 請勿施加側向壓力來減慢切割盤的運轉速度。
- 僅使用轉速與設備標籤上要求的轉速更快的砂輪。
- 請勿使用任何有破損、裂開或有其他損壞情況的砂輪。
- 請勿在未佩戴保護裝備的情況下操作。
- 在設備運作時，雙手請勿觸碰轉輪。以免受傷。
- 支撐面板或工件，以降低因切割片卡住而導致回彈的風險。大型工件可能因自重而彎曲。工件須在切割片兩側提供支撐，不僅靠近切割片處，還包括邊緣部分。

## 正反轉切換鈕

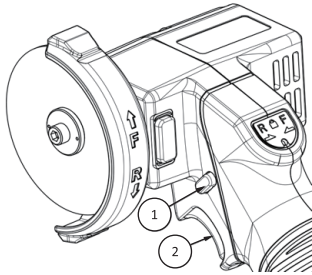

1.正反轉切換鈕 2.扳機

正反轉切換鈕可設置為三個位置：正轉、反轉和鎖定。由於鎖定機制，當扳機未被按下時，正反轉切換鈕才可進行調整。在使用正反轉切換鈕前，務必讓馬達完全停止運轉。

- 要啟動工具，請扣動扳機。釋放扳機以停止運轉。
- 若要**正轉**（逆時針）旋轉，請將正反轉切換鈕推向所示方向。**使用前請檢查旋轉方向。**
- 若要**反轉**（順時針）旋轉，請將正反轉切換鈕推向所示方向。**使用前請檢查旋轉方向。**

## 電池規格&安全使用事項

EB14020-A1	
額定電壓	14.4V
額定容量	2Ah
電池類型	鋰離子
尺寸	長 x 寬 x 高 89 x 59 x 105 (mm)

- 請勿將電池燒掉，也不要將電池拿去加熱。
- 請勿拆卸或重組電池組。
- 請勿將電池放在高溫的地方（60°C或以上）。
- 請勿讓電池受潮或碰水。
- 請勿讓電池受到大力撞擊，也不要讓電池落地。
- 請勿直接將鉛焊接到電池本體。
- 請勿加熱或焊接電池的端子。
- 請勿使電池正、負端子短路。
- 請遵守運送規則上所述的條件。
- 請勿反向充電或逆向連接電池。
- 充電時，請用 EC1412-A1 專用充電器。
- 請定期檢查電池容量。當電池的電壓低於開路電壓時，電池容量可能會下降且無法恢復。
- 如果電池放置時間超過3個月，應再次檢查剩餘容量並為電池充電。

**備註：**請參考電池規格技術數據表。

## 電池規格與安全使用事項

電池充電器規格	
充電器	EC1412-A1
電池模式	EB14020-A1
輸出電壓	EB14020-A1 需 16.6V
保護等級	觸電防止保護等級 II
交流供電電壓	100VAC~240VAC
主要頻率	50Hz~60Hz
作業溫度	0°C to 45°C
儲存溫度	-20°C to 70°C

充電狀態指標			
	狀態	LED紅燈	LED綠燈
1	待機狀態	關閉	閃爍 (0.5秒開，0.5秒關)
2	電池組安裝與充電	開啟	關閉
3	定電壓 (CV) 充電模式	關閉	閃爍 (0.1秒開，0.1秒關)
4	定電流 (CC) 充電模式	開啟	關閉
5	充電完成	關閉	開啟
6	溫度保護	LED紅燈閃爍	
7	異常保護	LED 紅、綠燈皆亮起	

## 電池充電器安全使用事項

- 保持工作場地乾淨且明亮。雜亂或昏暗的環境容易引發事故。
- 請勿在易爆環境中操作工具，例如在有易燃液體、氣體或粉塵的環境中。充電器可能會產生火花，這些火花可能引燃粉塵或煙霧。
- 充電時，請讓兒童和人群遠離充電區域。
- 電源線插頭必須與插座匹配。任何方式的插頭修改都是不允許的。未經修改的插頭和相應的電源插座能夠降低電擊危險。
- 避免身體與接地的表面(如管道、散熱器、爐具和冰箱)接觸。如果身體接觸接地的表面，會增加電擊危險。
- 請勿以錯誤方式使用電源線。請勿使用電源線來搬運、拉扯或拔掉設備插頭。避免電線接觸高溫、油污、尖銳邊緣或活動零件。受損或纏繞的電線會增加觸電風險。
- 請僅於乾燥的地方進行充電。電器受潮會增加觸電風險。
- 僅使用原廠出品對應的充電器為對應的電池充電。
- 請勿使用缺陷損壞的充電器或電源線。
- 不使用時將充電器存放在兒童無法拿到的地方。請勿讓不熟悉該設備或這些操作說明的人員操作充電器。讓未經訓練的使用者操作充電器是相當危險的。
- 請小心維護保養此產品。檢查確保沒有任何零件損壞或損毀以至於無法正常運轉。如果有損壞，請在使用前送修完畢。
- 請依照本說明使用充電器和相應電池，並且符合此型號之規定。以免使用不相容的充電器導致發生危險。
- 僅使用原廠指定的充電器進行充電。適用於一種電池組的充電器，若用於其他電池組，可能會引發火災風險。
- 不使用時，請將電池和充電器遠離迴紋針、硬幣、鑰匙、釘子、螺絲或其他可能導致電池端子或充電接觸點短路的小金屬物體。電池端子或充電接觸點的短路可能導致人身傷害(燒傷)或引起火災。
- 在不當使用情況下，電池可能會釋放液體；請避免接觸。如不慎接觸，請用水沖洗。若液體接觸到眼睛，請立即就醫。電池釋放的液體可能會引起刺激或灼傷。
- 請小心確保充電器放置在穩定、安全的位置。掉落的電池或充電器可能對您或他人造成傷害風險。
- 避免觸碰接點。

- 為避免環境污染，請務必妥善地處理廢電池。
- 身體、感官或心智能力受限、缺乏經驗和知識的人(包括兒童)不適合用本產品，除非他們在監督或指導之狀況下使用之。
- 請教育兒童不應隨意把玩此產品。
- 請小心確保電池不受機械損傷。
- 請勿充電或繼續使用損壞的電池(例如有裂痕、破損、彎曲或壓入或拉出接點的電池)。
- ⚠ 在工作期間，如果電源線或延長線損壞，請勿觸碰。請立即拔掉電源插頭並與電源插座斷開連接。損壞的電源線或延長線會帶來觸電的風險。
- 請勿在設備髒污或潮濕的情況下操作。若在不環境下，設備表面附著濕氣或灰塵，尤其是導電材料的灰塵，可能會引發觸電風險。因此，髒污或積塵的設備應定期送至售服中心檢查，特別是經常用於處理導電材料的情況下。

## 維護保養

▲警告：為了降低傷害風險，在進行任何維護保養工作前，請務必拔掉充電器插頭並將充電器或工具的電池組移除。請勿拆解工具、電池組或充電器。聯絡售服中心進行所有維修。

## 維護工具

- 通過定期維護計劃，保持工具、電池組和充電器處於良好狀態。檢查工具是否存在異常噪音、活動零件對不准或卡住、零件破損或任何其他可能影響工具操作的情況。將工具、電池組和充電器送交經銷商的售服中心。
- 如果工具在使用充滿電的電池組時無法啟動或無法全力運行，請清潔電池組上的接觸點。如果工具仍無法正常運作，請將工具、充電器和電池組送交經銷商的售服中心。

▲警告：為了降低傷害和損壞率，請勿讓工具、電池組或充電器泡水或受潮。

## 清潔

- 清理通風口的灰塵和木屑。保持握把清潔、乾燥，並無油脂或潤滑劑。
- 僅使用溫和的肥皂和濕布進行清潔，因為某些清潔劑和溶劑對塑料和其他絕緣零件有害。這些清潔劑包括汽油、松節油、清漆稀釋劑、油漆稀釋劑、含氯清潔劑、氨水以及含氨的家庭清潔劑。
- 請勿在工具周圍使用易燃或可燃的溶劑。

## 維修

如需維修，請將工具、電池組和充電器送至最近的售服中心。



## 故障排除

當保護功能啟動時，工具的指示燈會閃爍以發出提示，詳細信息如下表所示：

【注意】每間隔1.5秒就會閃爍，閃爍頻率為0.25秒。

異常提示	發生異常	故障排除
持續閃爍一次	<ul style="list-style-type: none"><li>■ 電池電壓保護</li></ul>	<ul style="list-style-type: none"><li>■ 關掉工具，重新裝入電池，然後按下扳機。</li><li>■ 更換已充滿電的電池，然後按下扳機。</li><li>■ 若問題仍然存在，請聯繫售服中心。</li></ul>
持續閃爍兩次	<ul style="list-style-type: none"><li>■ 工具馬達溫度保護</li><li>■ 工具電池溫度保護</li><li>■ 工具控制面板溫度保護</li></ul>	<ul style="list-style-type: none"><li>■ 關掉工具，重新裝入電池，然後按下扳機。</li><li>■ 移除電池，等待溫度恢復後再重新安裝電池。</li><li>■ 若問題仍然存在，請聯繫售服中心。</li></ul>
持續閃爍三次	<ul style="list-style-type: none"><li>■ 工具過電流</li></ul>	<ul style="list-style-type: none"><li>■ 關掉工具，重新裝入電池，然後按下扳機。</li><li>■ 若問題仍然存在，請聯繫售服中心。</li></ul>
工具無法正常運作 且電池狀態顯示燈 未閃爍。	<ul style="list-style-type: none"><li>■ 工具馬達異常</li></ul>	<ul style="list-style-type: none"><li>■ 關掉工具，重新裝入電池，然後按下扳機。</li><li>■ 若問題仍然存在，請聯繫售服中心。</li></ul>
若出現上述情況以外的故障，請立即停止使用工具並聯繫當地經銷商尋求服務。		

電話:+886-4-2359-8877

地址:臺中市西屯區工業區36路24號